



LICENSING (HEARING) SUB COMMITTEE

Date: TUESDAY, 19 MARCH 2019

Time: 2.30 pm

**Venue: COMMITTEE ROOM 1 - 2ND
FLOOR WEST WING, GUILDHALL**

Applicant: City Centre Events Ltd

**Premises: The Pelt Trader, Arch 3,
Dowgate Hill, London, EC4N 6AP**

CONTENTS

Hearing Procedure	(Pages 1 - 2)
Report of the Director of Markets & Consumer Protection	(Pages 3 - 10)
Appendix 1: Copy of Application	(Pages 11 - 32)
Appendix 2: Premises Licence	(Pages 33 - 42)
Appendix 3: Conditions consistent with the operating schedule	(Pages 43 - 44)
i) Letter to residents	(Pages 45 - 50)
Appendix 4: Representations from responsible authorities	
i) Environmental Health	(Pages 51 - 52)
Appendix 5: Representations from Other Persons	
i) Resident 1	(Pages 53 - 54)
ii) Resident 2	(Pages 55 - 56)
Appendix 6: Plan of Premises	(Pages 57 - 58)
Appendix 7: Map of subject premises together with other licensed premises in the area and their latest terminal time for alcohol sales	(Pages 59 - 60)

LICENSING (HEARING) SUB COMMITTEE PROCEDURE FOR PUBLIC HEARINGS

1. This procedure shall apply to all public hearings conducted under the provisions of the Licensing Act 2003.
2. Public hearings conducted under the provisions of the Licensing Act 2003 shall take the form of a discussion led by the licensing authority. Cross-examination will be permitted when the Sub Committee considers it to be required. The conduct of hearings shall be broadly based, subject to the discretion of the Sub Committee, on the points set out below.
3. At the start of the hearing the Chairman of the Sub Committee will introduce him/herself and other Members of the Sub Committee as well as the City Corporation officers present. Anyone making representations will then be asked to introduce themselves and anyone accompanying them. The applicant will then do likewise.¹
4. The Chairman will then explain the purpose of the hearing and the procedure to be followed at the hearing. The Sub Committee will then make any rulings necessary in respect of requests for witnesses to be heard in support of any of the parties making representations or the applicant.
5. Those making representations will then be invited to present their case. Repetition will not be permitted. Equal time will be offered to the applicant and those making representations. Where there is more than one party making representations and/or calling witnesses in support, consideration should be given to having one spokesman on behalf of all parties so as to avoid repetition. Although the use of a spokesman will be encouraged by the Sub Committee, the decision rests with those parties making representations.
6. In the event of disorder or persistent disregard of the authority of the Chair, the Chairman may suspend or adjourn the hearing, or require that the person(s) causing disorder or showing disregard leave the hearing.
7. In the event that the Sub Committee has decided that cross-examination will be permitted, the applicant will be invited to ask questions of the party(s) making representations and their witnesses (if any). The party(s) making representations and any witnesses giving evidence in support will then answer any questions put to them by members of the Sub Committee.
8. The applicant will then be invited to present their case and call any witnesses in support of their application. The applicant will be entitled to the same period of time to present his case as those making representations were afforded.

¹ In hearings where a licence is being reviewed, references in this procedure to 'applicant' should be read as references to the licence holder and references to 'those making representations' should be read as references to those applying for the review.

9. In the event that the Sub Committee has decided that cross-examination will be permitted, those making representations will be invited to ask questions of the applicant and their witnesses (if any). The applicant and any witnesses giving evidence in support will then answer any questions put to them by members of the Sub Committee.
10. The Chairman will ask all parties if there is anything else they would like to add in support of their respective cases.
11. Those making representations will then be invited to make closing submissions followed by the applicant.
12. The Sub Committee will then retire to consider their decision. They may call for assistance by the representatives of the Town Clerk and/or the Comptroller & City Solicitor but those persons will play no part in the decision-making process.
13. In due course, the Sub Committee will return to announce their decision or to inform those present when the decision will be given.

Committee(s): Licensing Sub-Committee	Hearing Date(s): 19 March 2019	Item no. 1
Subject: Licensing Act 2003 – Variation of a premises license Name of premises: The Pelt Trader Address of premises: Arch 3, Dowgate Hill EC4N 6AP		
Report of: Director of Markets and Consumer Protection		Public / Non-Public
Ward (if appropriate): Dowgate		

1 Introduction

- 1.1 To consider and determine, by public hearing, the application for a variation of a premises license under the Licensing Act 2003, taking into account the representations of a responsible authority and ‘other persons’ detailed in paragraphs 4 & 5, and the policy considerations detailed in paragraph 6 of this report.
- 1.2 The decision of the Sub-Committee must be made with a view to promoting one or more of the four licensing objectives, namely:
- the prevention of crime and disorder
 - public safety
 - the prevention of public nuisance
 - the protection of children from harm

2 Summary of Application

- 2.1 An application made by:
City Centre Events Ltd
Tavistock Hotel
Bedford Way
London
WC1H 9EU

was received by the City of London Licensing Authority on 25 January 2019 for a variation of the premises licence in respect of:

The Pelt Trader
Arch 3
Dowgate Hill
EC4N 6AP

- 2.2 Full details of the application are contained in the copy of the Application Form at Appendix 1.
- 2.3 The variation is to change the following activities:

<u>Activity</u>	<u>Current Licence</u>	<u>Proposed</u>
Supply of Alcohol off the Premises	Mon – Sat 10.00 – 21.00	Mon–Sat 10:00 – 22:30
	Sun 11.00 – 21.00	Sun 11.00 – 22.30

- 2.4 The premises are licensed to sell alcohol on the premises between the hours of 10.00 – 23.00 Monday to Wednesday, 10.00 – 00.00 Thursday to Saturday and 11.00 – 23.00 Sunday. Off-sales in unsealed containers are restricted to 21.00 every night. A copy of the Premises Licence can be seen in Annex 2.
- 2.5 The Operating Schedule submitted by the applicant seeks to change the condition restricting off-sales at 21.00 to 22.30 and also suggests an outdoor management plan intended to promote the four licensing objectives. Those conditions which are consistent with the operating schedule and could be included on the licence are attached as Appendix 3.
- 2.6 Additionally, on 8 March 2019, the applicant's solicitor wrote to all objectors offering a number of concessions (including a possible reduction of off-sales to 22.00) and further conditions. This letter is attached as Appendix 3 (i).
- 2.7 The mandatory licence conditions can be found in the Licensing Act 2003, sections 19-21. Also, in the Schedules to The Licensing Act 2003 (Mandatory Licensing Conditions) Order 2010 (as amended) and The Licensing Act 2003 (Mandatory Conditions) Order 2014.

3 Licensing History of Premises

- 3.1 The unit is an arch beneath Cannon Street Station which has previously been used as a sorting office for lost property.
- 3.2 It was converted into a bar in 2012 and the first Premises Licence was granted on 11th February 2013 to Jonathan Dalton.
- 3.3 The licence was granted after a hearing before the Sub-Committee following objections from a Ward Member, Environmental Health, Workers in Cannon Bridge House and residents of Dowgate Hill including the Worshipful Companies. Off-sales in unsealed containers were restricted to the hours of 19.00 – 21.00. This was to allay concerns that the pavement would be obstructed when people were leaving work after 17.00.
- 3.4 Six months later the licence holder applied for a variation to permit off-sales in unsealed containers during all hours up until 21.00. It was contended that the bar had traded without any concerns during its first summer and a management plan would be put in place to prevent obstruction during the evening rush-hour. Further objections were received from workers and residents, but the application was granted by the Sub-Committee on 3rd September 2013.
- 3.5 The licence was transferred to City Centre Events Ltd on 13 June 2014.
- 3.6 On 20th March 2017 the licence holder applied for another variation to permit off-sales in unsealed containers until 22.00. However, following talks between themselves, Environmental Health and residents the application was withdrawn.

Complaints

- 3.7 There have been no recent complaints in respect of this site. Whilst the pavement outside the bar can get very busy on certain nights, visits have shown that management keep patrons within a chalk line and regularly clear away glassware. There have been no recorded incidents of the 21.00 curfew having been breached.

4 Representations from Responsible Authorities

- 4.1 One representation has been received from the Environmental Health Office Pollution Team. It is stated that if granted the variation will undermine the objective of “prevention of public nuisance”.

5 Representations From Other Persons

- 5.1 There are two representations from ‘other persons’. These have come from residents of the Worshipful Company of Skinners who share the same concerns regarding ‘the prevention of public nuisance’.
- 5.2 The representations can be seen in full as Appendix 4(i) to 4(iii).

6 Policy Considerations

- 6.1 In carrying out its licensing functions, the Licensing Authority must have regard to its Statement of Licensing policy and statutory guidance issued under s 182 of the Licensing Act 2003.

City of London Corporation’s Statement of Licensing Policy

- 6.2 The following sections/paragraphs of the City of London Corporation’s Statement of Licensing Policy are particularly applicable to this application.

Paragraphs 79 – 81 address the need of care when controlling noise particularly from those persons leaving a premises.

The boxed comment on page 19 states the need to strike a fair balance between the benefits to a community of a licensed venue, and the risk of disturbance to local residents and workers.

The boxed comment on page 19 also states an overriding policy principle namely, that each application will be decided on its individual merits.

The boxed comment on page 22 considers various factors that should be taken into account when considering whether any licensable activity should be permitted.

Paragraphs 115-121 state the Corporation's policy on setting conditions which may be applicable dependant on the step(s) taken by members as stated in paragraph nine of this report.

Statutory Guidance

- 6.3 The following sections/paragraphs of the statutory guidance issued under s182 of the Licensing Act 2003 are particularly applicable to this application (revised April 2017):

Chapter 2 of the guidance covers the four licensing objectives. In particular, paragraph 2.15 states that it is, '...important that in considering the promotion of [*the public nuisance licensing objective, licensing authorities*] focus on the effect of the licensable activities at the specific premises on persons living and working (including those carrying on business) in the area around the premises which may be disproportionate and unreasonable.' Also, paragraph 2.16 indicates that the prevention of public nuisance could, in appropriate circumstances include, 'the reduction of the living and working amenity and environment of other persons living and working in the area of the licensed premises'.

Chapter 10 refers to conditions attached to premises licences with paragraph 10.10 stating that, 'Conditions should be determined on a case-by-case basis and standardised conditions which ignore these individual aspects should be avoided.' Also, 'Licensing authorities should therefore ensure that any conditions they impose are only those which are appropriate for the promotion of the licensing objectives.'

7 Map and Plans

- 7.1 A map showing the location of the premises together with nearby licensed premises is attached at Appendix 5. A key of those premises is included which indicates the maximum permitted hours for alcohol sales in respect of each premises along with the latest terminal hour for any other licensed activity if greater.
- 7.2 Plans of the premises are attached as Appendix 6.

8 Summary

- 8.1 The Licensing Authority has a duty under the Licensing Act 2003 to promote the Licensing Objectives. Each objective has equal importance. In carrying out its licensing functions, the Licensing Authority must also have regard to its Statement of Licensing Policy, any Statutory Guidance under the Licensing Act 2003 and is bound by the Human Rights Act 1998. The Corporation must also fulfil its obligations under section 17 of the Crime and Disorder Act 1998 to do all that it reasonably can to prevent crime and disorder in the City.

9 Options

- 9.1 The Sub-committee must, having regard to the representations, take such of the following steps as it considers appropriate for the promotion of the licensing objectives:
- i) grant the variation subject to any conditions consistent with the operating schedule modified to such extent as the Sub-committee considers appropriate for the promotion of the licensing objectives and include the mandatory conditions contained in Ss. 19-21 of the Licensing Act 2003;
 - ii) Reject the application.

For the purposes of paragraph 9.1(i) conditions consistent with the operating schedule are modified if any of them are altered or omitted or any new condition is added.

- 9.2 Where a licensing authority takes one or more of the steps stated in paragraph 9.1 above the applicant, or the holder of the licence and/or a person who made relevant representations in relation to the application, may appeal the decision to the Magistrates' Court. Any appeal must be commenced within 21 days following notification of the decision to the appellant by the licensing authority.

10 Recommendation

10.1 It is therefore RECOMMENDED that your Sub-Committee determine this variation of a premises licence in accordance with paragraph 9 of this report.

Prepared by Andre Hewitt
 Licensing Officer
 andre.hewitt@cityoflondon.gov.uk

Background Papers

<u>BACKGROUND PAPER</u>	<u>DEPT</u>	<u>FILE</u>
Corporation of London Statement of Licensing Policy (revised Jan 2017) Statutory Guidance – ‘Revised Guidance Issued Under Section 182 Of The Licensing Act 2003’. April 2017	MCP	5th Floor Walbrook Wharf Statutory Guidance

This page is intentionally left blank

Application to vary a premises licence under the Licensing Act 2003

PLEASE READ THE FOLLOWING INSTRUCTIONS FIRST

Before completing this form please read the guidance notes at the end of the form. If you are completing this form by hand please write legibly in block capitals. In all cases ensure that your answers are inside the boxes and written in black ink. Use additional sheets if necessary.

You may wish to keep a copy of the completed form for your records.

I/We City Centre Events Limited

(Insert name(s) of applicant)

being the premises licence holder, apply to vary a premises licence under section 34 of the Licensing Act 2003 for the premises described in Part 1 below

Premises licence number
LN/200503540

Part 1 – Premises Details

Postal address of premises or, if none, ordnance survey map reference or description
The Pelt Trader, Arch 3 Dowgate Hill



Post town	London	Postcode	EC4N 6AP
-----------	--------	----------	----------

Telephone number at premises (if any)

Non-domestic rateable value of premises £79,100

Part 2 – Applicant details

Daytime contact telephone number	[REDACTED]
E-mail address (optional)	[REDACTED]
Current postal address if different from premises address	[REDACTED] Bedford Way
Post town	London
Postcode	WC1H 9EU

Part 3 – Variation

Please tick as appropriate

Do you want the proposed variation to have effect as soon as possible?

☒ Yes

☐
No

If not, from what date do you want the variation to take effect?

DD		MM		YYYY			
1	1	1	1	1	1	1	1

Do you want the proposed variation to have effect in relation to the introduction of the late night levy? (Please see guidance note 1) ☐ Yes ☒ No

Please describe briefly the nature of the proposed variation (Please see guidance note 2)

The applicant is seeking to amend the condition that currently reads:

'There shall be no sale of alcohol off the premises in unsealed containers after 21:00hrs', to read:

'There shall be no sale of alcohol off the premises in unsealed containers after 22:30hrs'.

The applicant also proposes adding the following condition:

'An outside area management plan will be drawn up and implemented to ensure that as far as practicable, customers do not either block the pavement or act in a manner that would undermine the licensing objectives.'

there are no changes to the licensable activities or times they are undertaken at the premises

If your proposed variation would mean that 5,000 or more people are expected to attend the premises at any one time, please state the number expected to attend:

NA

Part 4 Operating Schedule

Please complete those parts of the Operating Schedule below which would be subject to change if this application to vary is successful.

Provision of regulated entertainment (Please see guidance note 3) Please tick all that apply

- a) plays (if ticking yes, fill in box A) ☐
- b) films (if ticking yes, fill in box B) ☐
- c) indoor sporting events (if ticking yes, fill in box C) ☐
- d) boxing or wrestling entertainment (if ticking yes, fill in box D) ☐
- e) live music (if ticking yes, fill in box E) ☐
- f) recorded music (if ticking yes, fill in box F) ☐
- g) performances of dance (if ticking yes, fill in box G) ☐
- h) anything of a similar description to that falling within (e), (f) or (g) (if ticking yes, fill in box H) ☐

Provision of late night refreshment (if ticking yes, fill in box I) ☐

Supply of alcohol (if ticking yes, fill in box J) ☐

In all cases complete boxes K, L and M

A

Plays Standard days and timings (please read guidance note 8)			<u>Will the performance of a play take place indoors or outdoors or both – please tick</u> (please read guidance note 4)	Indoors	<input type="checkbox"/>
				Outdoors	<input type="checkbox"/>
				Both	<input type="checkbox"/>
Day	Start	Finish	<u>Please give further details here</u> (please read guidance note 5)		
Mon					
Tue			<u>State any seasonal variations for performing plays</u> (please read guidance note 6)		
Wed					
Thur			<u>Non standard timings. Where you intend to use the premises for the performance of plays at different times to those listed in the column on the left, please list</u> (please read guidance note 7)		
Fri					
Sat					
Sun					

B

Films Standard days and timings (please read guidance note 8)			<u>Will the exhibition of films take place indoors or outdoors or both – please tick (please read guidance note 4)</u>		Indoors	<input type="checkbox"/>
					Outdoors	<input type="checkbox"/>
					Both	<input type="checkbox"/>
Day	Start	Finish	<u>Please give further details here (please read guidance note 5)</u>			
Mon						
Tue						
			<u>State any seasonal variations for the exhibition of films (please read guidance note 6)</u>			
Wed						
Thur						
			<u>Non standard timings. Where you intend to use the premises for the exhibition of films at different times to those listed in the column on the left, please list (please read guidance note 7)</u>			
Fri						
Sat						
Sun						

C

Indoor sporting events Standard days and timings (please read guidance note 8)			<u>Please give further details</u> (please read guidance note 5)
Day	Start	Finish	
Mon			
Tue			<u>State any seasonal variations for indoor sporting events</u> (please read guidance note 6)
Wed			
Thur			
Fri			<u>Non standard timings. Where you intend to use the premises for indoor sporting events at different times to those listed in the column on the left, please list</u> (please read guidance note 7)
Sat			
Sun			

D

Boxing or wrestling entertainments Standard days and timings (please read guidance note 8)			<u>Will the boxing or wrestling entertainment take place indoors or outdoors or both – please tick (please read guidance note 4)</u>		Indoors	<input type="checkbox"/>
					Outdoors	<input type="checkbox"/>
					Both	<input type="checkbox"/>
Day	Start	Finish				
Mon			<u>Please give further details here (please read guidance note 5)</u>			
Tue						
Wed			<u>State any seasonal variations for boxing or wrestling entertainment (please read guidance note 6)</u>			
Thur						
Fri			<u>Non standard timings. Where you intend to use the premises for boxing or wrestling entertainment at different times to those listed in the column on the left, please list (please read guidance note 7)</u>			
Sat						
Sun						

E

Live music Standard days and timings (please read guidance note 8)			<u>Will the performance of live music take place indoors or outdoors or both – please tick</u> (please read guidance note 4)	Indoors	<input type="checkbox"/>
				Outdoors	<input type="checkbox"/>
				Both	<input type="checkbox"/>
Day	Start	Finish	<u>Please give further details here</u> (please read guidance note 5)		
Mon					
Tue			<u>State any seasonal variations for the performance of live music</u> (please read guidance note 6)		
Wed			<u>Non standard timings. Where you intend to use the premises for the performance of live music at different times to those listed in the column on the left, please list</u> (please read guidance note 7)		
Thur					
Fri					
Sat					
Sun					

F

Recorded music Standard days and timings (please read guidance note 8)			<u>Will the playing of recorded music take place indoors or outdoors or both – please tick (please read guidance note 4)</u>	Indoors	<input type="checkbox"/>
				Outdoors	<input type="checkbox"/>
				Both	<input type="checkbox"/>
Day	Start	Finish	<u>Please give further details here (please read guidance note 5)</u>		
Mon					
Tue					
			<u>State any seasonal variations for the playing of recorded music (please read guidance note 6)</u>		
Wed					
Thur					
			<u>Non standard timings. Where you intend to use the premises for the playing of recorded music at different times to those listed in the column on the left, please list (please read guidance note 7)</u>		
Fri					
Sat					
Sun					

G

Performances of dance Standard days and timings (please read guidance note 8)			<u>Will the performance of dance take place indoors or outdoors or both – please tick</u> (please read guidance note 4)	Indoors	<input type="checkbox"/>
				Outdoors	<input type="checkbox"/>
				Both	<input type="checkbox"/>
Day	Start	Finish	<u>Please give further details here</u> (please read guidance note 5)		
Mon					
Tue			<u>State any seasonal variations for the performance of dance</u> (please read guidance note 6)		
Wed			<u>Non standard timings. Where you intend to use the premises for the performance of dance at different times to those listed in the column on the left, please list</u> (please read guidance note 7)		
Thur					
Fri					
Sat					
Sun					

H

Anything of a similar description to that falling within (e), (f) or (g) Standard days and timings (please read guidance note 8)			Please give a description of the type of entertainment you will be providing		
Day	Start	Finish	<u>Will this entertainment take place indoors or outdoors or both – please tick</u> (please read guidance note 4)	Indoors	<input type="checkbox"/>
Mon				Outdoors	<input type="checkbox"/>
				Both	<input type="checkbox"/>
Tue			<u>Please give further details here</u> (please read guidance note 5)		
Wed					
Thur			<u>State any seasonal variations for entertainment of a similar description to that falling within (e), (f) or (g)</u> (please read guidance note 6)		
Fri					
Sat			<u>Non standard timings. Where you intend to use the premises for the entertainment of a similar description to that falling within (e), (f) or (g) at different times to those listed in the column on the left, please list</u> (please read guidance note 7)		
Sun					

I

Late night refreshment Standard days and timings (please read guidance note 8)			<u>Will the provision of late night refreshment take place indoors or outdoors or both – please tick</u> (please read guidance note 4)	Indoors	<input type="checkbox"/>
				Outdoors	<input type="checkbox"/>
				Both	<input type="checkbox"/>
Day	Start	Finish	<u>Please give further details here</u> (please read guidance note 5)		
Mon					
Tue					
Wed			<u>State any seasonal variations for the provision of late night refreshment</u> (please read guidance note 6)		
Thur					
Pri			<u>Non standard timings. Where you intend to use the premises for the provision of late night refreshment at different times, to those listed in the column on the left, please list</u> (please read guidance note 7)		
Sat					
Sun					

J

Supply of alcohol Standard days and timings (please read guidance note 8)			Will the supply of alcohol be for consumption – please tick (please read guidance note 9)	On the premises	<input type="checkbox"/>
				Off the premises	<input type="checkbox"/>
Day	Start	Finish		Both	<input type="checkbox"/>
Mon			<u>State any seasonal variations for the supply of alcohol</u> (please read guidance note 6)		
Tue					
Wed					
			<u>Non-standard timings. Where you intend to use the premises for the supply of alcohol at different times to those listed in the column on the left, please list</u> (please read guidance note 7)		
Thur					
Fri					
Sat					
Sun					

K

<p>Please highlight any adult entertainment or services, activities, other entertainment or matters ancillary to the use of the premises that may give rise to concern in respect of children (please read guidance note 10).</p> <p>None</p>
--

L

Hours premises are open to the public Standard days and timings (please read guidance note 8)			<u>State any seasonal variations (please read guidance note 6)</u>
Day	Start	Finish	<u>Non standard timings. Where you intend the premises to be open to the public at different times from those listed in the column on the left, please list (please read guidance note 7)</u>
Mon			
Tue			
Wed			
Thur			
Fri			
Sat			
Sun			

Please identify those conditions currently imposed on the licence which you believe could be removed as a consequence of the proposed variation you are seeking.

'There shall be no sale of alcohol off the premises in unsealed containers after 21:00hrs',

to be amended to read:

'There shall be no sale of alcohol off the premises in unsealed containers after 22:30hrs'.

Please tick as appropriate

- I have enclosed the premises licence ☒
- I have enclosed the relevant part of the premises licence ☒

If you have not ticked one of these boxes, please fill in reasons for not including the licence or part of it below

Reasons why I have not enclosed the premises licence or relevant part of premises licence.

M Describe any additional steps you intend to take to promote the four licensing objectives as a result of the proposed variation:

a) General – all four licensing objectives (b, c, d and e) (please read guidance note 11)

No changes to current licence

b) The prevention of crime and disorder

No changes to current licence

c) Public safety

No changes to current licence

d) The prevention of public nuisance

There shall be no sale of alcohol off the premises in unsealed containers after 22:30hrs

An outside area management plan will be drawn up and implemented to ensure that as far as practicable, customers do not either block the pavement or act in a manner that would undermine the licensing objectives

e) The protection of children from harm

No changes to current licence

Checklist:**Please tick to indicate agreement**

- I have made or enclosed payment of the fee; or ☒
- I have not made or enclosed payment of the fee because this application has been made in relation to the introduction of the late night levy. ☐
- I have sent copies of this application and the plan to responsible authorities and others where applicable. ☐
- I understand that I must now advertise my application. ☒
- I have enclosed the premises licence or relevant part of it or explanation. ☒
- I understand that if I do not comply with the above requirements my application will be rejected. ☒

IT IS AN OFFENCE, UNDER SECTION 158 OF THE LICENSING ACT 2003, TO MAKE A FALSE STATEMENT IN OR IN CONNECTION WITH THIS APPLICATION. THOSE WHO MAKE A FALSE STATEMENT MAY BE LIABLE ON SUMMARY CONVICTION TO A FINE OF ANY AMOUNT.

Part 5 – Signatures (please read guidance note 12)

Signature of applicant (the current premises licence holder) or applicant's solicitor or other duly authorised agent (please read guidance note 13). If signing on behalf of the applicant, please state in what capacity.

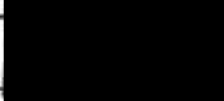

Signature	
Date	24/01/2019
Capacity	Solicitors to the applicant

Where the premises licence is jointly held, signature of 2nd applicant (the current premises licence holder) or 2nd applicant's solicitor or other authorised agent (please read guidance note 14). If signing on behalf of the applicant, please state in what capacity.

Signature	
Date	
Capacity	

Contact name (where not previously given) and address for correspondence associated with this application (please read guidance note 15)

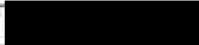
Piers Warne
TLT Solicitors
1 Redcliff Street

Post town	Bristol	Post code	BS1 6TP
Telephone number (if any)			
If you would prefer us to correspond with you by e-mail, your e-mail address (optional)			
			

Notes for Guidance

This application cannot be used to vary the licence so as to extend the period for which the licence has effect or to vary substantially the premises to which it relates. If you wish to make that type of change to the premises licence, you should make a new premises licence application under section 17 of the Licensing Act 2003.

1. You do not have to pay a fee if the only purpose of the variation for which you are applying is to avoid becoming liable for the late night levy
2. Describe the premises. For example, the type of premises, its general situation and layout and any other information which could be relevant to the licensing objectives. Where your application includes off-supplies of alcohol and you intend to provide a place of consumption of these off-supplies of alcohol, you must include a description of where the place will be and its proximity to the premises.
3. In terms of specific regulated entertainments please note that:
 - Plays: no licence is required for performances between 08.00 and 23.00 on any day, provided that the audience does not exceed 500.
 - Films: no licence is required for 'not-for-profit' film exhibition held in community premises between 08.00 and 23.00 on any day provided that the audience does not exceed 500 and the organiser (a) gets consent to the screening from a person who is responsible for the premises; and (b) ensures that each such screening abides by age classification ratings.
 - Indoor sporting events: no licence is required for performances between 08.00 and 23.00 on any day, provided that the audience does not exceed 1000.
 - Boxing or Wrestling Entertainment: no licence is required for a contest, exhibition or display of Greco-Roman wrestling, or freestyle wrestling between 08.00 and 23.00 on any day, provided that the audience does not exceed 1000. Combined fighting sports – defined as a contest, exhibition or display which combines boxing or wrestling with one or more martial arts – are licensable as a boxing or wrestling entertainment rather than an indoor sporting event.
 - Live music: no licence permission is required for:
 - a performance of unamplified live music between 08.00 and 23.00 on any day, on any premises.
 - a performance of amplified live music between 08.00 and 23.00 on any day on premises authorised to sell alcohol for consumption on those premises, provided that the audience does not exceed 500.
 - a performance of amplified live music between 08.00 and 23.00 on any day, in a workplace that is not licensed to sell alcohol on those premises, provided that the audience does not exceed 500.
 - a performance of amplified live music between 08.00 and 23.00 on any day, in a church hall, village hall, community hall, or other similar community premises, that is not licensed by a premises licence to sell alcohol, provided that (a) the audience does not exceed 500, and (b) the organiser gets consent for the performance from a person who is responsible for the premises.
 - a performance of amplified live music between 08.00 and 23.00 on any day, at the non-residential premises of (i) a local authority, or (ii) a school, or (iii) a hospital, provided that (a) the audience does not exceed 500, and (b) the organiser gets consent for the performance on the relevant premises from: (i) the local authority concerned, or (ii) the school or (iii) the health care provider for the hospital.
 - Recorded Music: no licence permission is required for:

- any playing of recorded music between 08.00 and 23.00 on any day on premises authorised to sell alcohol for consumption on those premises, provided that the audience does not exceed 500.
 - any playing of recorded music between 08.00 and 23.00 on any day, in a church hall, village hall, community hall, or other similar community premises, that is not licensed by a premises licence to sell alcohol, provided that (a) the audience does not exceed 500, and (b) the organiser gets consent for the performance from a person who is responsible for the premises.
 - any playing of recorded music between 08.00 and 23.00 on any day, at the non-residential premises of (i) a local authority, or (ii) a school, or (iii) a hospital, provided that (a) the audience does not exceed 500, and (b) the organiser gets consent for the performance on the relevant premises from: (i) the local authority concerned, or (ii) the school proprietor or (iii) the health care provider for the hospital.
- **Dance:** no licence is required for performances between 08.00 and 23.00 on any day, provided that the audience does not exceed 500. However, a performance which amounts to adult entertainment remains licensable.
 - **Cross activity exemptions:** no licence is required between 08.00 and 23.00 on any day, with no limit on audience size for:
 - any entertainment taking place on the premises of the local authority where the entertainment is provided by or on behalf of the local authority;
 - any entertainment taking place on the hospital premises of the health care provider where the entertainment is provided by or on behalf of the health care provider;
 - any entertainment taking place on the premises of the school where the entertainment is provided by or on behalf of the school proprietor; and
 - any entertainment (excluding films and a boxing or wrestling entertainment) taking place at a travelling circus, provided that (a) it takes place within a moveable structure that accommodates the audience, and (b) that the travelling circus has not been located on the same site for more than 28 consecutive days.
4. Where taking place in a building or other structure please tick as appropriate (indoors may include a tent).
 5. For example state type of activity to be authorised, if not already stated, and give relevant further details, for example (but not exclusively) whether or not music will be amplified or unamplified.
 6. For example (but not exclusively), where the activity will occur on additional days during the summer months.
 7. For example (but not exclusively), where you wish the activity to go on longer on a particular day e.g. Christmas Eve.
 8. Please give timings in 24 hour clock (e.g. 16.00) and only give details for the days of the week when you intend the premises to be used for the activity.
 9. If you wish people to be able to consume alcohol on the premises, please tick 'on the premises'. If you wish people to be able to purchase alcohol to consume away from the premises, please tick 'off the premises'. If you wish people to be able to do both, please tick 'both'.
 10. Please give information about anything intended to occur at the premises or ancillary to the use of the premises which may give rise to concern in respect of children regardless of whether you intend children to have access to the premises, for example (but not exclusively) nudity or semi-nudity, films for restricted age groups or the presence of gaming machines.
 11. Please list here steps you will take to promote all four licensing objectives together.
 12. The application form must be signed.

13. An applicant's agent (for example solicitor) may sign the form on their behalf provided that they have actual authority to do so.
14. Where there is more than one applicant, each of the applicants or their respective agents must sign the application form.
15. This is the address which we shall use to correspond with you about this application.

Application ref: city-of-london-744146
Licence: Application to vary a premises licence
Applicant email: [REDACTED]
Submitted on: 25/01/2019 14:55
Total fee: Variable
Payment status: Paid
WorldPay ref: 8787697949
Amount paid: £315.00

Application

application form

Supporting documents (2)

Copy of premises licence

Premises plan

Authority Reference

Reference:

Tacit consent applies

Process by: 01/03/2019

Status: Not collected

Recent History

Notification to
licensing@cityoflondon.gov.uk:
Sent on 25/01/2019 15:01

Notification to :
Failed on 25/01/2019 16:01

Payment Successful :
at 25/01/2019 14:57



**Licensing Act 2003
Section 24
Premises licence**

Trading Standards (Licensing Section), City of London
PO Box 270 Guildhall, London EC2P 2EJ

Premises licence number

LN/200503540

Part 1 - Premises details

Postal address of premises, or if none, ordnance survey map reference or description The Pelt Trader, Arch 3 Dowgate Hill	
Post town London	Post code EC4N 6AP
Telephone Number	

Where the licence is time limited - the dates

Licensable activities authorised by the licence

Alcohol Sales
Late Night Refreshment

The times the licence authorises the carrying out of licensable activities

Alcohol Sales

Sunday	11:00 - 23:00	-
Monday	10:00 - 23:00	-
Tuesday	10:00 - 23:00	-
Wednesday	10:00 - 23:00	-
Thursday	10:00 - 00:00	-
Friday	10:00 - 00:00	-
Saturday	10:00 - 00:00	-

Late Night Refreshment

Sunday	-	-
Monday	-	-
Tuesday	-	-
Wednesday	-	-
Thursday	23:00 - 00:00	-
Friday	23:00 - 00:00	-
Saturday	23:00 - 00:00	-

The opening hours of the premises**Opening Hours**

Sunday	07:00 - 23:30	-
Monday	07:00 - 23:30	-
Tuesday	07:00 - 23:30	-
Wednesday	07:00 - 23:30	-
Thursday	07:00 - 00:30	-
Friday	07:00 - 00:30	-
Saturday	07:00 - 00:30	-

Where the licence authorises supplies of alcohol - whether these are on and/or off supplies

On & Off the Premises

There shall be no sale of alcohol off the premises in unsealed containers after 21:00hrs

Part 2**Name, (registered) address, telephone number and email (where relevant) of holder of premises licence**

City Centre Events Limited
Basement of Tavistock Hotel
Bedford Way
London
WC1H 9EU

Registered number of holder, for example company number, charity number (where applicable)

07576490

Name, address and telephone number of designated premises supervisor where the premises licence authorises for the supply of alcohol

Lauren Macdougall
[REDACTED] St Gabriels Walk
London
SE1 6FB

Personal licence number and issuing authority of personal licence held by designated premises supervisor – where the premises licence authorises for the supply of alcohol

844687 - Southwark

Date granted 11th February 2013

Last Amendment 12th December 2018

Director of Port Health & Public Protection
Page 34

Annex 1 - Mandatory conditions

Alcohol

1. No supply of alcohol may be made under the Premises Licence –
 - (a) At a time when there is no Designated Premises Supervisor in respect of the Premises Licence; or
 - (b) At a time when the Designated Premises Supervisor does not hold a Personal Licence or his Personal Licence is suspended.
2. Every supply of alcohol under the Premises Licence must be made, or authorised by a person who holds a Personal Licence.
3.
 - (1) The responsible person must ensure that staff on relevant premises do not carry out, arrange or participate in any irresponsible promotions in relation to the premises.
 - (2) In this paragraph, an irresponsible promotion means any one or more of the following activities, or substantially similar activities, carried on for the purpose of encouraging the sale or supply of alcohol for consumption on the premises.
 - a) games or other activities which require or encourage, or are designed to require or encourage, individuals to –
 - (i) drink a quantity of alcohol within a time limit (other than to drink alcohol sold or supplied on the premises before the cessation of the period in which the responsible person is authorised to sell or supply alcohol), or
 - (ii) drink as much alcohol as possible (whether within a time limit or otherwise);
 - b) provision of unlimited or unspecified quantities of alcohol free or for a fixed or discounted fee to the public or to a group defined by a particular characteristic in a manner which carries a significant risk of undermining a licensing objective;
 - c) provision of free or discounted alcohol or any other thing as a prize to encourage or reward the purchase and consumption of alcohol over a period of 24 hours or less in a manner which carries a significant risk of undermining a licensing objective;
 - d) selling or supplying alcohol in association with promotional posters or flyers on, or in the vicinity of, the premises which can reasonably be considered to condone, encourage or glamorise anti-social behaviour or to refer to the effects of drunkenness in any favourable manner.
 - e) dispensing alcohol directly by one person into the mouth of another (other than where that other person is unable to drink without assistance by reason of disability).
4. The responsible person must ensure that free potable water is provided on request to customers where it is reasonably available.
5.
 - (1) The premises licence holder or club premises certificate holder must ensure that an age verification policy is adopted in respect of the premises in relation to the sale or supply of alcohol.

- (2) The designated premises supervisor in relation to the premises licences must ensure that the supply of alcohol at the premises is carried on in accordance with the age verification policy.
- (3) The policy must require individuals who appear to the responsible person to be under 18 years of age (or such older age as may be specified in the policy) to produce on request, before being served alcohol, identification bearing their photograph, date of birth and either:-
 - (a) a holographic mark or
 - (b) an ultraviolet feature.

6. The responsible person shall ensure that –

- (a) where any of the following alcoholic drinks is sold or supplied for consumption on the premises (other than alcoholic drinks sold or supplied having been made up in advance ready for sale or supply in a securely closed container) it is available to customers in the following measures –
 - (i) beer or cider: ½ pint;
 - (ii) gin, rum, vodka or whisky: 25 ml or 35 ml; and
 - (iii) still wine in a glass: 125 ml; and
- (b) these measures are displayed in a menu, price list or other printed material which is available to customers on the premises; and
- (c) where a customer does not in relation to a sale of alcohol specify the quantity of alcohol to be sold, the customer is made aware that these measures are available.

Minimum Drinks Pricing

- 1. A relevant person shall ensure that no alcohol is sold or supplied for consumption on or off the premises for a price which is less than the permitted price.
- 2. For the purposes of the condition set out in paragraph 1 –
 - (a) “duty” is to be construed in accordance with the Alcoholic Liquor Duties Act 1979
 - (b) “permitted price” is the price found by applying the formula –

$$P = D + (D \times V)$$

Where –

 - (i) P is the permitted price
 - (ii) D is the amount of duty chargeable in relation to the alcohol as if the duty were charged on the date of the sale or supply of the alcohol, and
 - (iii) V is the rate of value added tax chargeable in relation to the alcohol as if the value added tax were charged on the date of the sale or supply of the alcohol;
 - (c) “relevant person” means, in relation to premises in respect of which there is in force a premises licence –
 - (i) The holder of the premises licence

- (ii) The designated premises supervisor (if any) in respect of such a licence, or
 - (iii) The personal licence holder who makes or authorises a supply of alcohol under such a licence;
- (d) “relevant person” means, in relation to premises in respect of which there is in force a club premises certificate, any member or officer of the club present on the premises in a capacity which enables the member or officer to prevent the supply in question; and
- (e) “value added tax” means value added tax charged in accordance with the Value Added Tax Act 1994.
3. Where the permitted price given by Paragraph (b) of paragraph 2 would (apart from the paragraph) not be a whole number of pennies, the price given by that sub-paragraph shall be taken to be the price actually given by that sub-paragraph rounded up to the nearest penny.
4. (1) Sub-paragraph (2) applies where the permitted price given by Paragraph (b) of paragraph 2 on a day (“the first day”) would be different from the permitted price on the next day (“the second day”) as a result of a change to the rate of duty or value added tax.
- (2) The permitted price which would apply on the first day applies to sales or supplies of alcohol which take place before the expiry of the period of 14 days beginning on the second day.

If the Premises Licence allows Exhibition of Films

1. Where a premises licence authorises the exhibition of films, the licence must include a condition requiring the admission of children to the exhibition of any film to be restricted in accordance with this section.

2. Where the film classification body is specified in the licence, unless subsection (3)(b) applies, admission of children must be restricted in accordance with any recommendation by that body.

3. Where

- (a) The film classification body is not specified in the licence, or
- (b) The relevant licensing authority has notified the holder of the licence that this subsection applies to the film in question,

admission of children must be restricted in accordance with any recommendation made by that licensing authority.

4. In this section “children” means any person aged under 18; and

“film classification body” means the person or persons designated as the authority under Section 4 of the Video Recordings Act 1984(c39) (authority to determine suitability of video works for classification).

If the Premises Licence has conditions in respect of Door Supervision

except theatres, cinemas, bingo halls and casinos

1. Where a premises licence includes a condition that at specified times one or more individuals must be at the premises to carry out a security activity, each such individual must:

(a) be authorised to carry out that activity by a licence granted under the Private Security Industry Act 2001; or

(b) be entitled to carry out that activity by virtue of section 4 of the Act.

2. But nothing in subsection (1) requires such a condition to be imposed:

(a) in respect of premises within paragraph 8(3)(a) of Schedule 2 to the Private Security Industry Act 2001 (c12) (premises with premises licences authorising plays or films); or

(b) in respect of premises in relation to:

(i) any occasion mentioned in paragraph 8(3)(b) or (c) of that Schedule (premises being used exclusively by club with club premises certificate, under a temporary event notice authorising plays or films or under a gaming licence), or

(ii) any occasion within paragraph 8(3)(d) of that Schedule (occasions prescribed by regulations under that Act).

3. For the purposes of this section:

(a) “security activity” means an activity to which paragraph 2(1)(a) of that Schedule applies, and, which is licensable conduct for the purposes of that Act, (see Section 3(2) of that Act) and

(b) paragraph 8(5) of that Schedule (interpretation of references to an occasion) applies as it applies in relation to paragraph 8 of that Schedule.

Annex 3 - Conditions attached after a hearing by the licensing authority

The following conditions/resolutions were agreed by the City of London's Licensing Sub Committee at a hearing held on 3rd September 2013.

- 1. There shall be no sale of alcohol off the premises in unsealed containers after 21:00hrs**

Annex 4 - Plans

Licensing Drawing

Reference: 14727-001

Date: 17/12/12

This page is intentionally left blank

City Centre Events Ltd – Conditions Consistent With The Operating Schedule

- There shall be no sale of alcohol off the premises in unsealed containers after 22.30hrs.
- An outside area management plan will be drawn up and implemented to ensure that as far as practicable, customers do not either block the pavement or act in a manner that would undermine the licensing objectives.

This page is intentionally left blank

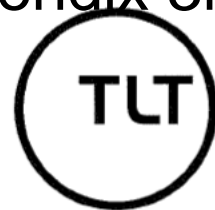

THE RESIDENT

Direct tel



Date

8 March 2019

Direct fax

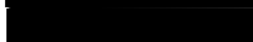

Email



Dear Resident

The Pelt Trader: 23 Dowgate Hill, London EC4N 6AP

I act for the applicants, City Centre Events Limited, in relation the variation for the Pelt Trader. We are responding to your comments and concerns raised in your representations. In doing so, we hope to give you a better understanding of why this application is being made and how the operators will look to work with you to address your concerns.

Reason for the application

Since opening, the management of the premises have been managing the external area to ensure that as far as possible customers do not cause a nuisance to pedestrians or persons living in the vicinity. Customers tend to be workers or visitors to the City and are mostly professionals and are well-behaved. There is no crime and disorder associated with the premises and since opening there has been no issue of trouble at the premises.

Customers often come in small groups after work to relax for a short time prior to going home. Given the later working hours and international nature of businesses in the vicinity, there is a regular turnover of customers over the course of an evening, with customers arriving, as well as leaving after 9pm (as with other leisure businesses in the area). Customers tend to react positively to the reasonable requests of staff and management, inside and outside the premises, when needed.

However, it has been a bone of contention for some customers that the external area closes at 9pm. Some customers just arriving after a hard day at work want to stand outside, having been inside and seated all day. They often point to the fact that other premises do not have a curfew of 9pm and have been known to leave to go to other nearby premises. In the summer, some customers will not come at all if they know they will be ushered inside at 9pm. This is both a point of frustration for staff and customers alike.

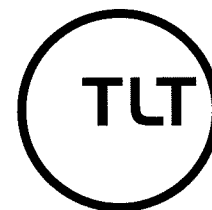

The application has therefore been made to seek a modest increase to rectify these issues.

Representations

The owners and management team at the premises take your concerns seriously and want to work with you in relation to ensuring that the premises manages customers of the premises properly. We have attached for your information the updated management plan relating to use of the external area and noise management in general. We hope that this give you some comfort that your concerns are taken seriously.

Amendment to the application

Following consideration of your representation, the applicants are offering to close the external area to customers at 10pm, rather than 10:30pm as set out in the application. They feel that this is a fair compromise, balancing the needs of all parties.

Proposed additional conditions

In addition, the applicants propose that the following conditions are added to the premises licence application:

- The external area shall be managed as far as practicable to ensure that customers do not behave in a manner that is likely to cause a public nuisance. For the avoidance of doubt, this condition does not seek to prevent customers from engaging socially as would be expected a social situation, but requires a degree of management of customers should their behaviour become overly loud or deemed to be offensive.
- An 'Outside area management plan and general noise management plan' shall be drawn up and implemented at the premises ('the plan') to ensure that as far as practicable the external area is properly supervised. The plan is to be made available at the premises for inspection by an authorised officer of the Council or Police on request.
- A prominent sign will be displayed in the door leading to the external area reminding customers to respect the fact that there are residents living nearby.
- A complaints log will be maintained by the DPS ('the log'). The log will be used to record any complaints made by residents or other people working in the area in relation to the operation of the premises. The log will record the date, time and nature of the complaint, along with the name of the person making the record and any action taken in relation to that complaint.

We hope that these proposed conditions go some way to addressing your concerns.

Meeting with Lauren MacDougal

The manager, Lauren, would be delighted to meet you and give you any further detail you require in relation to this application. As such, she will be at the Pelt Trader on Monday 11 March between 6 and 7pm and available to speak to you. Simply ask for her at the bar.

Invitation to withdraw your representation

We hope that this letter has gone some way to mitigating your concerns and offering a greater insight into what is being sought. As such, and if you feel that your concerns have been addressed, then I would invite you to withdraw your representation by contacting the licensing officer at licensing@cityoflondon.gov.uk

However, please feel free to contact me in order to discuss this application or anything in this letter.

Yours sincerely

Piers Warne
Associate
for TLT LLP



Front outside area management plan and general noise plan

Measures taken for supervision and management of guests outside the front of the premises

When the outside area is likely to be busy, in particular early Thursday and Friday evenings during hot sunny weather, the Duty Manager will appoint a single person to supervise the areas ('the supervisor') from 5pm onwards. The supervisor will be instructed that their sole duty will be the supervision of the outside areas until it closes or unless for any other reason it is empty (such as bad weather forcing all or most guests inside).

The supervisor will be also be responsible for keeping the outside areas tidy of glass, crockery etc.

The supervisor may be given additional roles and responsibilities that are located outside as required.

Guests will be supervised to ensure that they do not block the pavement or encroach on the road. Anyone found there is to be asked firmly and politely to move back into the designated area.

Guests acting unreasonably, such as shouting, singing or swearing excessively, or not moving on request will be reminded that as a courtesy to neighbours and other guests that noise must be kept to a reasonable level.

If the guests persist, the Duty Manager should be informed

If required, The Duty Manager should again ask the guests to reduce the noise to a reasonable level or they will be asked to leave the outside area.

If they continue to make noise, they will be required to leave the outside area.

No glasses will be permitted to be taken outside from 22:00 hours. Thereafter, only smokers will be permitted outside.

Signage and other information to be used to remind guests using the outside areas do so in a way which will not cause a public nuisance to nearby residents.

A sign will be displayed in a prominent position at the exit to make our guests aware of the consequences of late night noise and to be respectful to the neighbours. Signs will also state the closing times of the external area.

Dealing with complaints from residents

In the event of any complaint being received this will be dealt with immediately by a member of the management team and the details recorded in writing. A complaints record book will be collated and a record will be kept at all times. This will be regularly reviewed by the management team to identify any reoccurring incidents. All management team will be effectively trained on how to deal with complaints and accurate record keeping.

All staff members required to undertake duties in relation to this management plan will be asked to read a copy of this plan and a copy will be available to staff during their shifts if needed.

Other Noise management measures

Deliveries

Suppliers will be instructed to deliver only between the hours of 10am and 5pm daily. On occasion where this is not possible due to scheduling issues, no deliveries will be accepted before 8am. This will be made clear to suppliers.

Rubbish collection

Bin collection is from the service yard underneath Cannon Street station in Cannon place. Businesses within Cannon Street station and the offices above also use the bins. Collection is organised by the station, not the Pelt Trader. However, no glass bottles will be emptied into bins outside the frontage of the premises, nor when the doors to the front of the premises are open.

This page is intentionally left blank

Hewitt, Andre

From: Seal, Garry
Sent: 20 February 2019 14:47
To: Davenport, Peter
Cc: M&CP - Licensing
Subject: Application for variation of premises licence - Arch 3 Dowgate Hill London EC4N 6AP

Peter Davenport

The pollution team at Environmental Health, Markets and Consumer Protection are making a representation as a responsible authority.

The representation is made for the licensing objection of the prevention of Public Nuisance.

There are a number of residential premises in close proximity to the Pelt Trader in Dowgate Hill:

4 Dowgate Hill – 3 Flats

8 Dowgate Hill – 3 Flats

11-13 Dowgate Hill – 3 Flats

The team is aware that residents are affected by the noise by patrons drinking outside the Pelt Trader until 9.00 pm and also by patrons who go outside to smoke after 9.00 pm.

It is considered that any extension in the hours that drinks are permitted to be consumed outside the premises will increase any nuisance to the nearby residents. A restriction to 9.00 pm would be in accordance with similar agreements in the City when there are nearby residents.

Regards

Garry



Garry Seal
Environmental Health Officer
Pollution Team

Markets and Consumer Protection
City of London, Walbrook Wharf
78-83 Upper Thames Street
London
EC4R 3TD



NOTE: New hours for noisy works on Saturdays throughout the city are 09:00 to 14:00.

Updated SHVR: <https://www.cityoflondon.gov.uk/business/environmental-health/environmental-protection/Documents/3a-Site-Hours-Variation-Request-Sheet-Jan-2018.pdf>

Register non-road mobile machinery (NRMM) via this link: nrmm.london

Should you wish to provide feedback on the service you have received, please follow this link: survey.monkey.com/r/PHPP_Noise

This page is intentionally left blank

Wayne Taylor

Co' WC Skinners', Skinners' hall,
Dowgate Hill,
London, EC4R 2SP.



Date: 18th February 2019

Re: Objection to the proposed change of conditions attached to premises license number:
LN/200503540 - Pelt Trader's licence at Arch 3, 23 Dowgate Hill, London, EC4R.

Dear licensing team,

I would like to raise a strong objection to the proposed extension of one and half hours to the conditions of the licence enabling patrons of the Pelt Trader to consume drinks outside the premises until 10:30pm.

As a resident of the Dowgate ward for the past 11 years and who's main residence overlooks said business, one has had to tolerate the additional noise generated by the patrons standing outside the venue Mon-Fri evenings - especially in the summer months. (loud talking/shouting, singing, dropped glass wear – could the use of plastic receptacles for outside drinking be enforced - like Westminster council applies?)

We have seen the overspill of customers on Thurs/Fri evenings spread up Dowgate Hill and onto the road which has completely changed the quiet fabric of the Dowgate Ward.

As a former publican for over ten years I am acutely aware of the responsibilities of the licensee and the awareness they need to have for their neighbours. I am also conscious that it is almost impossible to control the volume of people after a few drinks on a lovely sunny evening, however this is my home and the noise generated by those members of the public drinking outside is a daily problem especially at the end of the week in warmer months, the noise in such an enclosed street reverberates between the buildings even with the windows closed it continues to be audible.

Therefore, I do strongly object to having this extended by 1.5 hrs. and hope the licensing team empathise with the points raised above in favour of the local business and residents.

I look forward to your reply

Your sincerely

Mr Wayne Taylor

This page is intentionally left blank

Breese, Robert

From: Andrew Kennett CB CBE <[REDACTED]>
Sent: 20 February 2019 10:37
To: M&CP - Licensing
Cc: Gowman, Alison (Alderman); Wayne Taylor
Subject: Re: Application for variation of premises licence - Arch 3 Dowgate Hill London EC4N 6AP Dowgate ward

To whom it may concern,

I am writing to register my formal objection to the request by The Pelt Trader at Arch 3, Dowgate Hill for an extension to their hours of operation. My bedroom is directly above the street in which their noisy, smoking and inconsiderate customers shout and drink. Their use of the street as a bar is already unacceptable, not least for the negative image it paints of City life.

My routine often requires early morning work and I sleep from 9pm at night. This just about works with the current licence but would be an unholy intrusion with an extension to the licence. The noise from the bar is far too loud to permit sleep and in the early morning refuse collection, including the shattering sound of glass waste being emptied into recycling trucks, mean that sleep after 0530am is impossible.

This means that the Pelt Trader already condemns me to routine demanding sleep from 9 30pm to awake at 05-0530am. Any further extension to their operating hours cuts into an already short eight hour night. No one should be forced into a six or seven hour sleep pattern by a bar.

Yours faithfully,

Andrew Kennett
[REDACTED] Dowgate Hill.

Subject: FW: Application for variation of premises licence - Arch 3 Dowgate Hill London EC4N 6AP Dowgate ward

The Pelt trader have made an application to extend the hours of operation for off sales (drinking outside the premises) from 21hrs to 22:30hrs,

From: Gowman, Alison (Alderman) <[REDACTED]>
Sent: 05 February 2019 10:52
To: Gowman, Alison (Alderman) <[REDACTED]>
Subject: Fw: Application for variation of premises licence - Arch 3 Dowgate Hill London EC4N 6AP Dowgate ward

Dear Dowgate Friends

An application has been made by the Pelt Trader to extend the hours of operation for off sales. Any comments or objections need to be made by 22nd February as set out on the attached notice.

Kind regards

This page is intentionally left blank

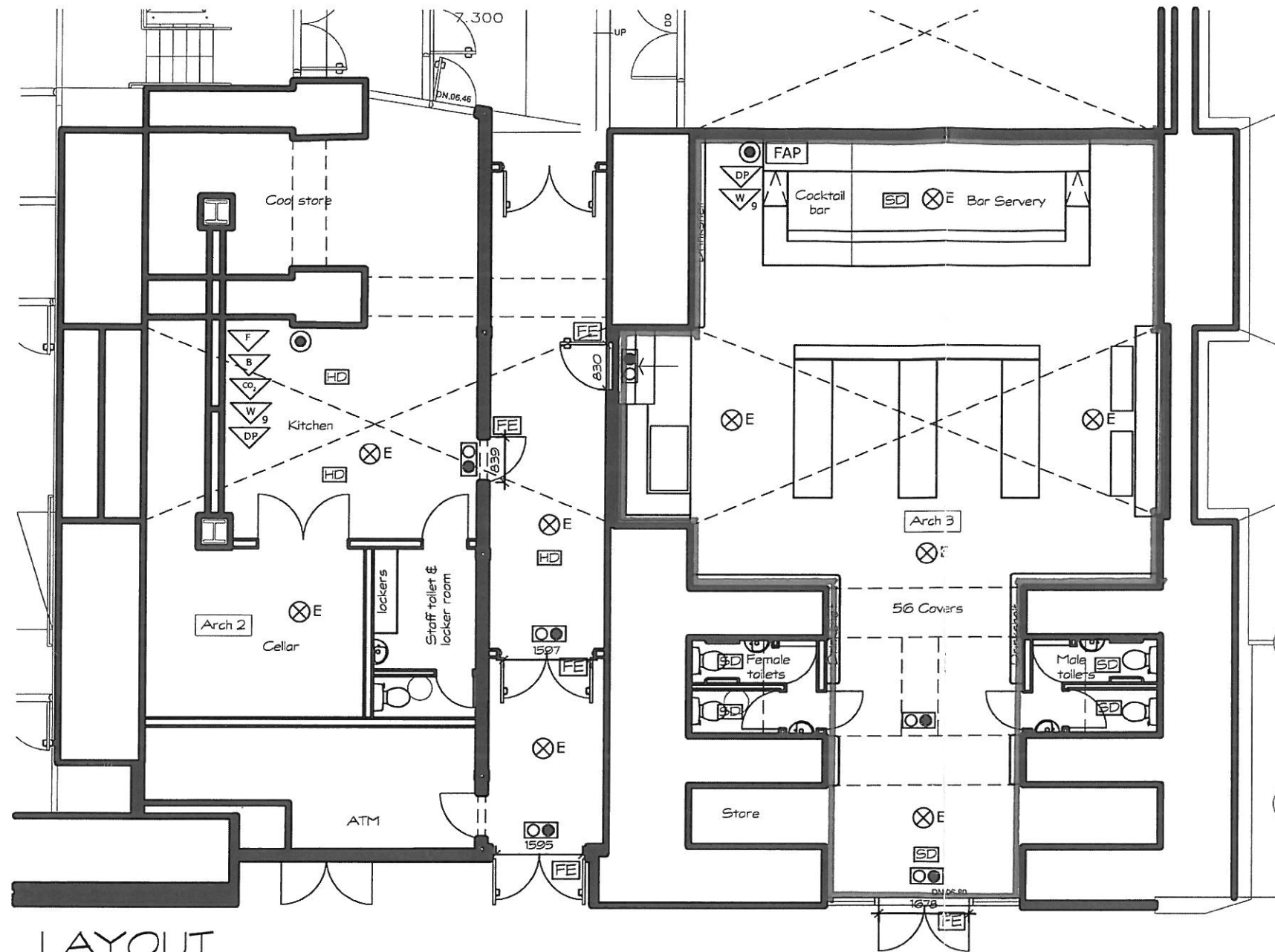

LAYOUT
Scale 1:100

FIRE PREVENTION KEY

THE LOCATION AND TYPE OF ANY FIRE SAFETY AND OTHER FIRE SAFETY EQUIPMENT IS SHOWN AS IT IS AT PRESENT. THIS MAY BE VARIED FROM TIME TO TIME WITH THE AGREEMENT OF THE FIRE OFFICER OR AFTER FIRE RISK ASSESSMENT.

- [FAP]** Fire Alarm Panel
- [EXIT]** Illuminated EXIT sign.
- ⊗E** Areas to be covered by emergency lighting. (Layout to be provided by electrician for approval)
Emergency lighting to be installed in accordance with BS 5266 Part 1:1988 & to achieve min. lighting level of 0.2 Lux on all Escape Routes.
- Break Glass Fire Alarm Call Point.

- [SD]** Automatic Smoke Detector with integral base sounder
- [HD]** Rate of Rise Heat Detector with integral base sounder
- [F]** Fire Alarm System to be installed in accordance with BS 5839 Part 1:1988.
- [F]** AFFF Extinguisher - 6 litre capacity.
- [CO2]** Co2 Extinguisher - 2 kg capacity.
- [DP]** Dry Powder Extinguisher - 2.25 kg or 4.5 kg capacity.
- [W9]** Water Extinguisher - 9 litre capacity.
- [B]** Fire Blanket - 1.2m x 1.2m.
- All fire fighting equipment to be in accordance with BS 5306.
- RED LINE INDICATES EXTENT OF WHERE ALCOHOL IS SOLD

© Andy Thornton Contracts Ltd.
No part of this drawing may be reproduced without prior written permission. Andy Thornton Contracts Ltd reserves all copyrights on its designs.
Many of the designs are also the subject of registered design right.

DO NOT SCALE IF IN DOUBT ASK

REV	DATE	DETAILS	INITIAL
PROJECT PELT TRADER			
CANNON STREET			
LONDON			
CLIENT BLOOMSBURY LEISURE			
JON DALTON			
TITLE LICENSING DRAWING			

DRG No. 14727-001 SCALE 1:100 @ A3

DRN BY K.P.RCHK BY DATE 17/12/12

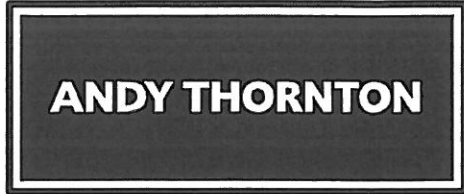

ANDY THORNTON CONTRACTS LIMITED
Ainleys Industrial Estate, Elland, West Yorkshire, HX5 9JP, England
Tel: +44 (0)1422 700 007 Fax: +44 (0)1422 700 008
Email: contracts@andythorntoncontracts.com
www.andythornton.com

This page is intentionally left blank

Premises Location Map

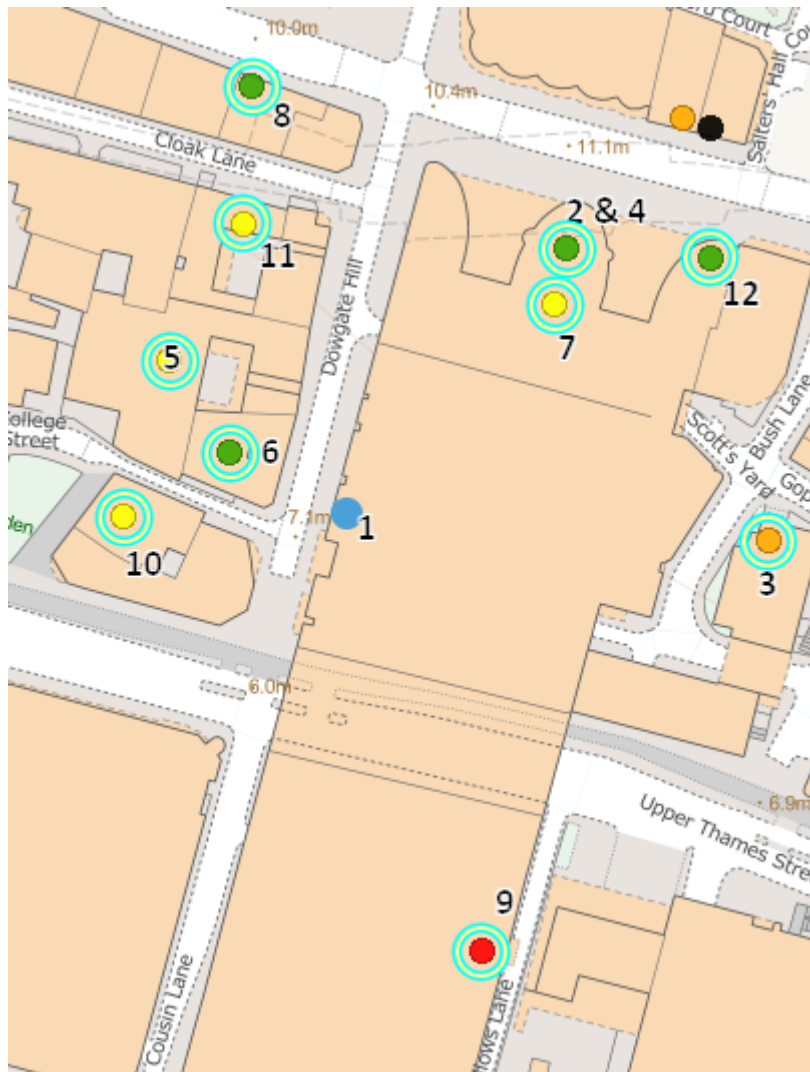

No:	Trade Name	Alcohol Closing Time	Late Night Refreshment Closing Time
1	Pelt		
2	CBI, 4th Floor	Midnight	Midnight
3	The Listing	01:00	01:00
4	Sodexo, Threadneedle Asset Management	23:00	Unlicensed
5	Worshipful Co of Skinners	Midnight	Midnight
6	Dyers Hall	23:00	Unlicensed
7	Sir John Hawkshaw	Midnight	Midnight
8	Krystals Express	23:00	Unlicensed
9	The Steel Yard	06:00	06:00
10	Worshipful Co of Innholders	Midnight	Midnight
11	Worshipful Co of Tallow Chandlers	23:59	23:59
12	Marks & Spencer Simply Food	23:00	Unlicensed

This page is intentionally left blank